



SPECIFICATION F530

PRINCIPAL DIMENSIONS *(according to ISO 8666)*

LOA	16.13 m	52' 9"
Beam	4.56 m	14' 9"
Draught	1.37 m	4' 5"
Height above waterline inc. mast	6.05 m TBC	19' 8"
Height above waterline excl. mast	4,40 m TBC	14' 4"
Fuel capacity	1560 l	342 UK Gal
Water capacity	766 l	168 UK Gal
Displacement	18,1 t TBC	17,8 tn.l.
Max People on board	12	
CE Category	B	

ENGINE STANDARD

2 x Volvo Penta IPS 600 (435HP), Pod Drive
Propeller: TS6 26 knots*

ENGINE OPTIONAL

2 x Volvo Penta IPS 700 (550HP), Pod Drive
Propeller: TBC Max speed 29* TBC

2 x Volvo Penta IPS 800 (600HP), Pod Drive
Propeller: N4 Max speed 33 knots*

*All performance figures are given in good faith and are intended as an indication. These figures cannot be guaranteed as top speed in particular is affected by the cleanliness of the hull, conditions of the propellers, weight carried and air/sea temperature. Performance is related also to the optional accessories selected. SEALINE reserves the right to change specifications in line with the company policy of improvement through research and development. Errors and omissions expected. Please check with your dealer for a full list of inclusions.

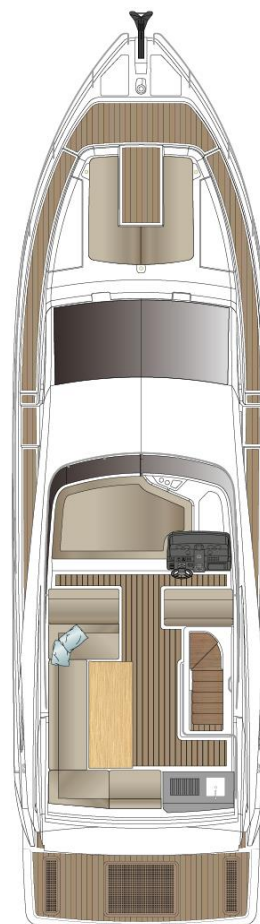

Flybridge



Main Deck

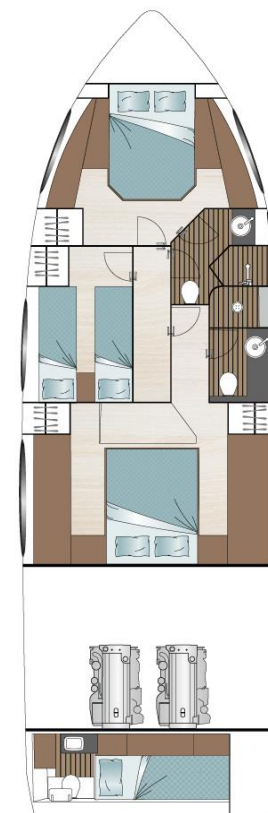

Lower Deck
crew cabin optional

DECK

- Anchor Hauser stainless steel
- Anchor locker, self draining with S/S tie bar for fenders under lids
- Deck moulding, non slip
- Fender strip, white with stainless inlay
- Foredeck hatch, opening
- Navigation lights
- Stainless steel pulpit
- All cleats are stainless steel
- 6 Mooring cleats
- Shore power connector
- Large, full windshield screen, clear toughened glass
- Full glass side window to port and starboard, with opening door on starboard side
- Air inlet for engine room
- Two box storage in bow area
- U-shaped bench at bow

COCKPIT AND BATHING PLATFORM

- Anthracite aft pillars
- Cockpit, self draining
- Seating bench at stern and port side
- Bifold door to the salon
- Tilting window to the kitchen
- Storage box
- Manual bilge pump
- Cockpit lights
- Bathing platform, teak laid
- Step to cockpit in teak
- Step to flybridge in teak
- Bathing ladder with handrail
- Handrails in stainless steel
- Bathing shower with hot and cold water
- Foldable teak bar
- Access hatch to engine room (manual)

FLYBRIDGE

- Double Copilot seat
- Large U-shaped seating
- Storage locker under seating
- Handrail on entrance to flybridge
- Table, with teak insert and cup holders
- Rollbar in GRP for navigation equipment
- Anchor & steaming light, flag hooks
- Big forward sunpad area
- Wetbar with sink, hot/cold water and storage with GRP cover

UPPER HELM

- Pilot seat for two
- Sealine steering wheel

- Volvo engine instrumentation,
- Engine controls, joystick and lever throttles
- Tilt steering wheel on flybridge
- Compass
- Cup holders
- Storage

LOWER HELM

- Sealine steering wheel, Tilt
- Front screen demister
- Seat for helm and copilot
- Volvo engine instrumentation,
- Engine controls, joystick and throttles
- Compass, 12V DC Socket

SALOON

- Sideboard at starboard with storage
- U-shaped sofa at port side with possibility to convert into double facing sofa
- Surround panoramic windows
- Salon light
- Light system with dimmer
- Dining table with fixed leg
- Socket, double 230V (AC)

GALLEY

- Fridge with freezer
- lights
- Tilting window to cockpit
- Eye level cupboards
- Microwave with grill option
- 1 ½ Sink in stainless with mixer tap, and cover top
- Sockets, double 230V (AC)
- Electric hob two rings
- Storage

MASTER CABIN

- Queen size bed
- Vanity desk with mirror
- Wardrobes with lockers to port & stbd
- Drawers
- Mirrors
- Magnetic floor mounted door stops
- Door to head and shower
- Hull window to port and starboard with storage underneath
- Port light stbd (1), opening
- Two bed side table
- Sockets, single (230V AC) port & stbd
- Reading lights
- Cabin lights
- Indirect lights (led) in the ceiling and around bed basement

- Bed head and bed frames
- Light system with dimmer
- Carpet to floor

MASTER CABIN EN-SUITE

- Hand washbasin with mixer tap
- Toilet light
- Mirror above the sink
- Porthole, opening
- Shaver socket
- Toilet, Electric

MASTER EN-SUITE SHOWER

- Lighting
- Translucent door to the head
- Handheld shower with column
- Rain shower with light
- Shower seat with teak cover

VIP CABIN

- Berth, double with drawer
- Wardrobes to port
- Cup boards
- Bed head and bed frames
- Mirror on back of the entrance door
- Light system with dimmer
- Magnetic floor mounted door stops
- Door to head and shower
- Port light to stbd (1), opening
- Skylight hatch, opening with blind
- Skylight fixed, beside of opening hatch
- Bedside table port & stbd
- Sockets, (230V AC) port & stbd
- Reading lights
- Cabin lights
- Indirect lights (led)
- Carpet to floor

GUEST CABIN

- Two twin berths
- Storage under bed
- Cupboard and locker
- Door to the corridor
- Large hull windows, with opening
- Reading Lights (2)
- Cabin lights
- Light system with dimmer
- Indirect lights (led)
- Carpet floor
- Beds head and beds frames
- Sockets, (2) (230V AC)
- Bed table

DAY AND GUEST HEAD

- Door to the corridor
- Door to the VIP cabin
- Hand wash basin with mixer tap
- Toilet light
- Port light, opening
- Shaver socket
- Toilet, electric

DAY AND GUEST HEAD SHOWER

- Lighting
- Translucent door to the head
- Handheld shower with pillar

ELECTRICAL

- AC system, 230V with shore connection
- Shore power galvanic separation
- Batteries – service 3 x 260 AH 12V
- Batteries – engines 2 x 90 AH 12V
- Battery charger, 30A only for engine batteries
- Combi charger / Inverter 150A / 3000W
- Boiler with immersion heater (60 litre)
- DC system, 12V system
- Fresh water pump
- Water tank gauge
- Pantograph wipers, with screen wash
- Interceptors

MECHANICAL

- Water tank, capacity – 766 litres
- Holding tank 300 litres with electric macerator
- Fuel tank, capacity – 1560 litres
- Bilge pumps, automatic electric (2) and manual (1)
- Engine room sound proofing inc on Engine hatch
- Engine room fans (automatic)
- Engine room lights
- Engine room 230v Power socket
- Fire extinguisher system, automatic and manual, in engine room with controls at both helms
- Fuel filters for engines
- Steering, electric

DÉCOR

- Wellington wood furniture
- Flooring Wood Australian Acacia style in saloon and Galley
- Carpets on the cabins (according to colour selection)
- Upholstery interior - Fabric
- Mattresses
- Galley and heads work in Royal deep espresso Corian matt finishing
- Convertible Helm seat/chaiselongue in leather long island color Palissander

MISCELLANEOUS

- Hull white gel coat
- Identified locations for hand held fire extinguishers -
(hand held fire extinguishers are not supplied)
- Sealine Owners' Manual in Sealine bag
- Water line in gel coat